



COMUNE DI ZIMELLA  
PROVINCIA DI VERONA

INTERVENTI FINALIZZATI ALLA SICUREZZA STRADALE  
L.R. 39/93 ART. 9

**PROGETTO**  
**DEFINITIVO ED ESECUTIVO**

LAVORI MESSA IN SICUREZZA STRADALE  
VIA BRAGGIO IN SANTO STEFANO DI ZIMELLA  
I STRALCIO

ELABORATI GAFFICI  
STATO DI PROGETTO

ALLEGATO  
**D.1.2**

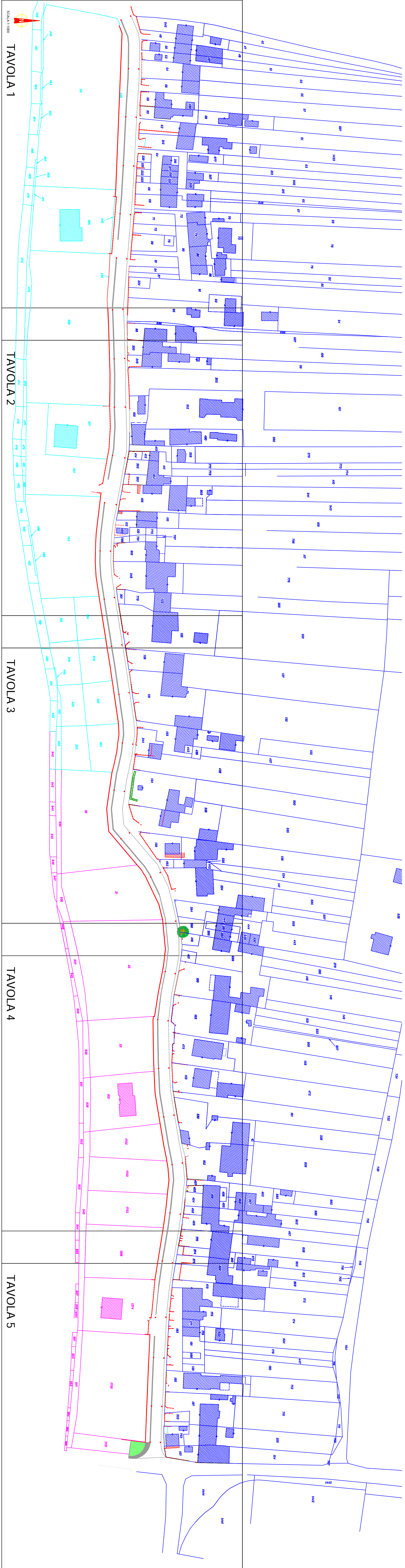

II STRALCIO I STRALCIO

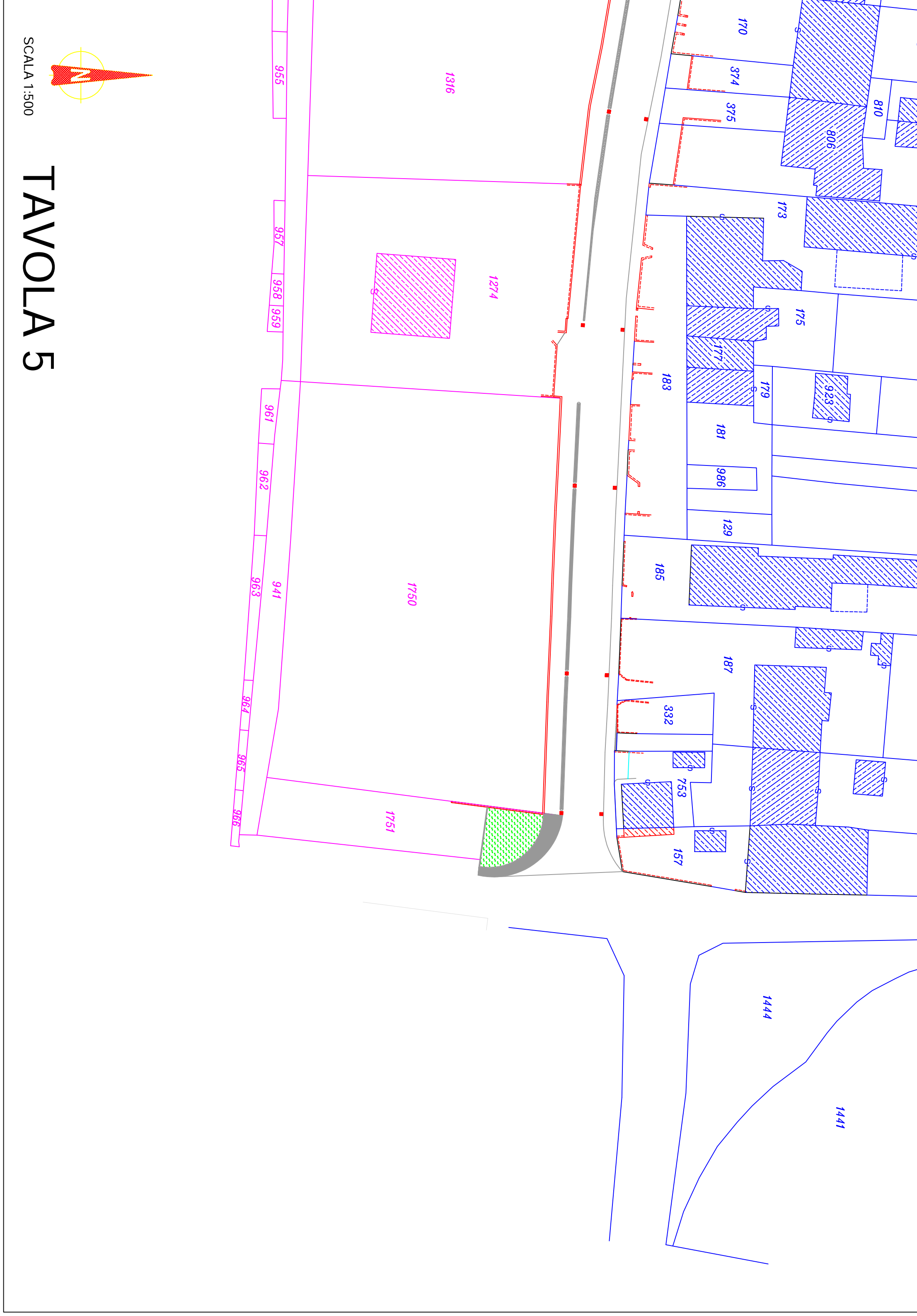
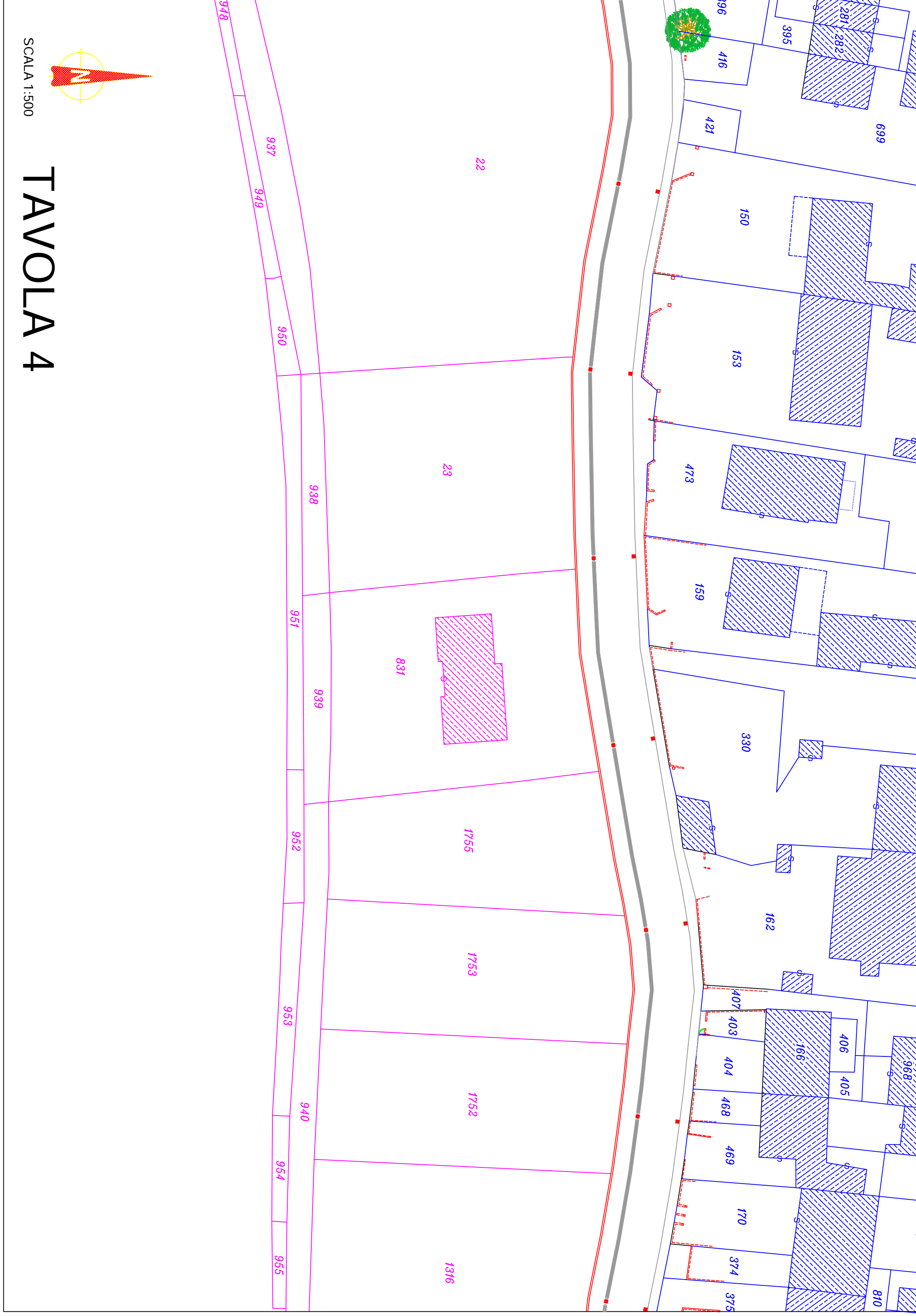
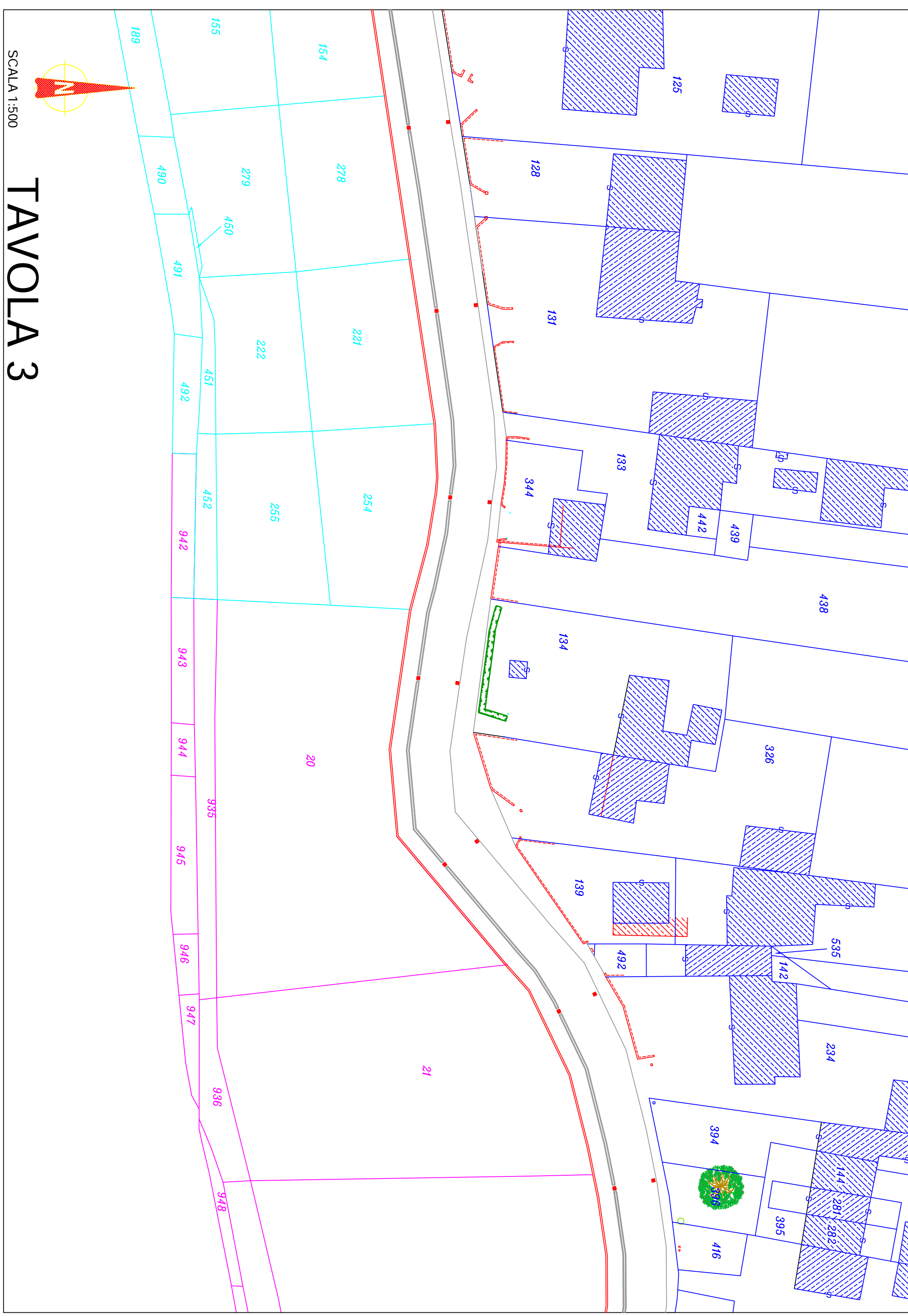

SCALA 1:500

TAVOLA 3

SCALA 1:500

TAVOLA 4

SCALA 1:500

TAVOLA 5